

Hub-Style Wheel Mount Assembly

Wheel mount is equipped with a tapered inside diameter to match the taper of the spindle shaft. The hub-style blade then slides over the straight arbor of the wheel mount, then locked into place with the large locknut.

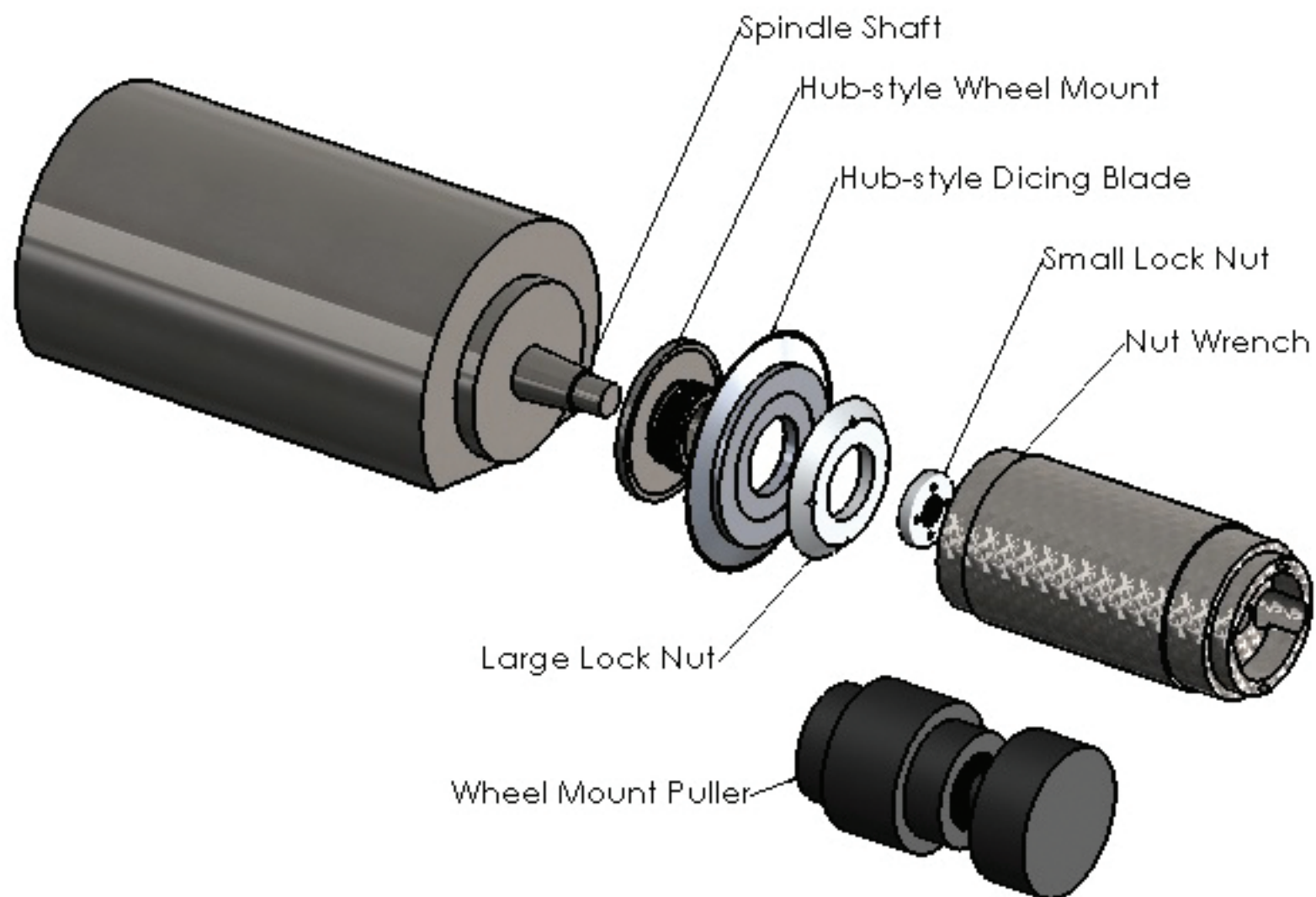

BA-Type Flange Assembly

Ideal for use in conjunction with saws already set up with the hub-style assembly.
Allows customers to quickly change between hub-style and hubless blades.

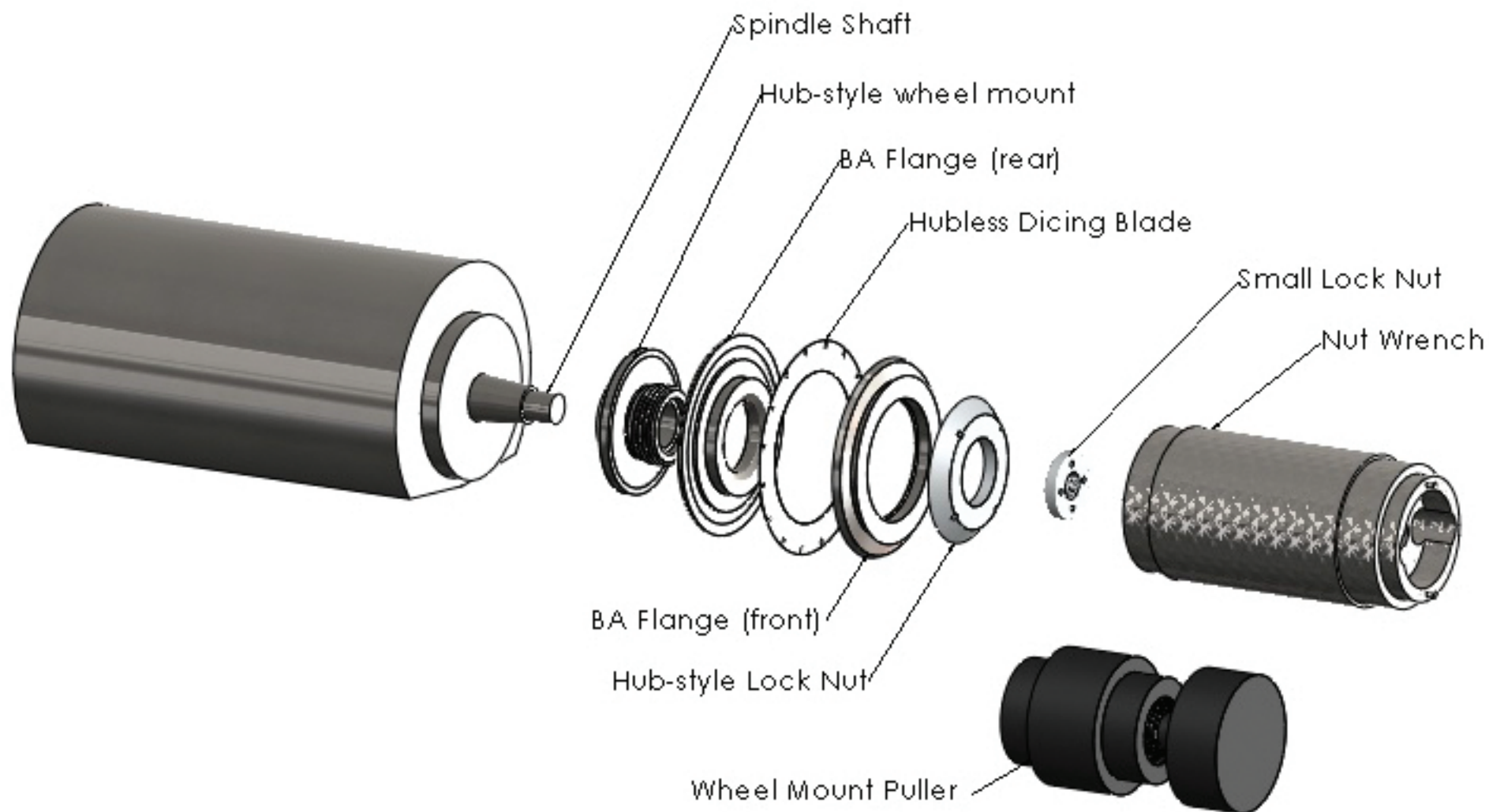

F-Type Flange Assembly

Unlike the tapered flange, the F-type flange uses a tapered wheel mount that interfaces with the spindle shaft, allowing the flange to easily be removed from the spindle during a blade change operation.

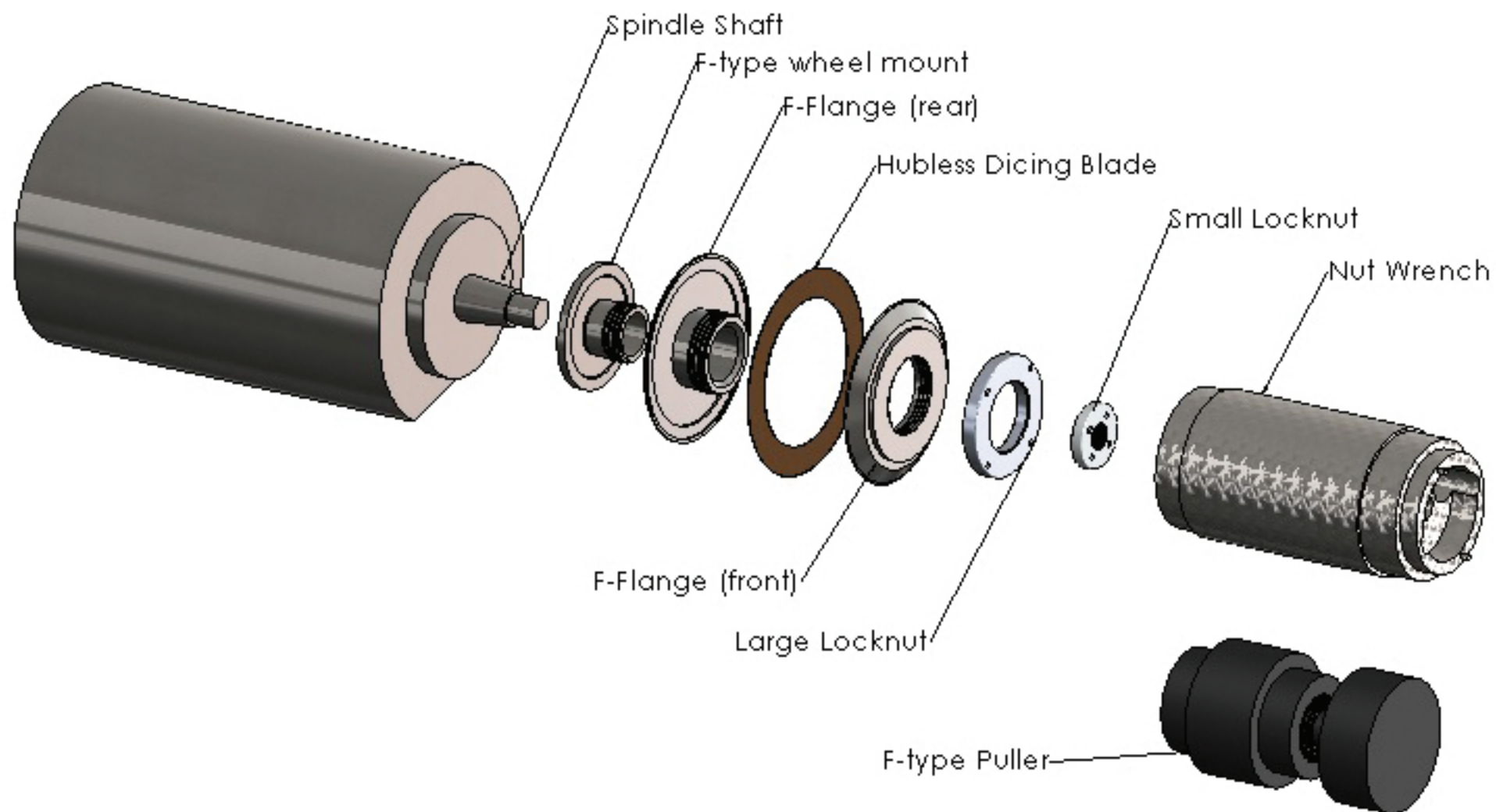

Tapered Flange Mount Assembly

Equipped with a tapered inside diameter to match the spindle shaft taper for more accuracy, and can be used with any hubless blade.

